

## 1 画线 Sketching

- (1) 在门内外两侧距离门底1米处画一条水平线，将开孔模板的把手中心线与水平线对齐，画出相应的开孔中心及轮廓线；
- (2) 在门上装锁芯的面上根据模板上的位置画出上下的扣条孔位线及上下的锁体边界线。

- (1) Draw a horizontal line on both sides, crossing the edge of the door, at 1m above the ground.
- (2) Place the drilling template on the door; make sure the handle center line on the template is exactly at the same level of the line marked in step (1). Mark all the lines and holes according to the template on the door by pencil for drilling.
- (3) Mark the Mortise line and side plate line on the door edge by pencil for drilling.

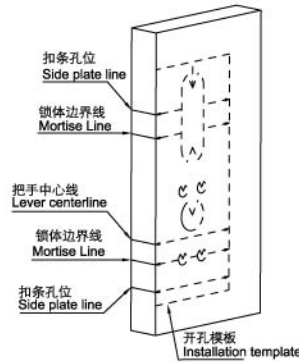

## 2 开孔 Drilling holes

- (1) 根据此安装步骤背面的开孔尺寸在门的内外及侧边画出详细的开孔轮廓线；
- (2) 钻孔：从门的内外侧钻孔，钻孔深度为门厚的一半，以免门被钻裂；
- (3) 修孔：用凿刀修整孔边缘，完成开孔后如右图所示：

- (1) Drill the holes marked on the door according to the diagram of "AD-E7F4 Drilling view of door and door frame";
- (2) Drill from both sides of the door to avoid damage to the door. The deepness of the hole from both sides of the door should not exist half of the door thickness;
- (3) Use appropriate tools to smooth the edge of the holes; the drilled door should be same as the diagram shown.

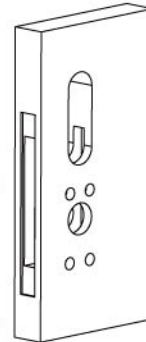

## 3 装锁芯 Install mortise

- (1) 将锁芯装到锁芯孔中；
- (2) 用四根M4\*25的沉头木螺丝将锁芯固定在门上。（如果是铁门，请用四根M5\*15的机牙螺钉）

- 备注：将锁芯装入门内时不要压住排线。
- (1) Place the mortise into the mortise hole probably;
  - (2) Use the M4\*25 screws provided to fix the mortise on the door.
- Remarks: When installing the mortise on the door, make sure that the mortise cable is not pressed by anything.

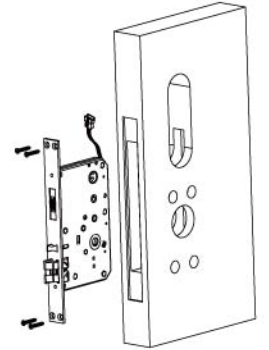

## 4 装前锁面 Installing the front lock body

- (1) 先将锁面胶垫装在前锁体上；
  - (2) 将前锁体上的锁头转轴对准锁芯上的锁头拔块孔装到门上；
- 注意：在装前锁体前请检查锁芯内锁头拔块的长方孔要与地面平行半圆缺口在下方。

- (1) Place the lock body gasket onto the front lock body;
  - (2) Install the front lock body onto the door; the cylinder spindle should be in the same direction with the cylinder hole in the mortise;
- Remarks: Before installing the front lock body, make sure that the SMEICIRCLE of the cylinder hole in the mortise is heading to the ground.

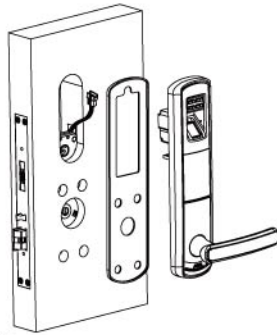

## 5 装后锁体 Install back lock body

- (1) 将锁面胶垫装在后锁体上。
  - (2) 将锁芯数据线 (4P) 与前锁体数据线连接好。
  - (3) 将后锁体出线 (6P) 与前锁体出线连接好。
  - (4) 将后锁体的方轴与锁芯中的羊角孔对齐插入装到门上，用一根M6螺钉和两根M5的螺钉固定好前后锁体。
- 注意：两组数据线连接好后要将多余长度部分整理好放入门孔中。

- (1) Place the lock body gasket onto the back lock body;
- (2) Connect the mortise cable (4P) to the main cable on the front lock body;
- (3) Connect the back lock body cable (6P) to the main cable on the front lock body;
- (4) Install the back lock body onto the door. Make sure the square spindle goes through the hole on the mortise and the circular parts of the spindle gets into the hole on the mortise. Use the M5 & M6 screws provided to fix the lock onto the door.

Remarks: Hide all the connected cables into the door holes before fixing the lock onto the door

注意：方轴穿过锁芯装入前锁体时，方轴上有UP字样的一面应在上方。  
Note: when inserting square shaft, make sure the mark "UP" is facing up.



## 6 装电池 Install battery

- (1) 装电池：根据电池盒上正负极的标识装入电池；
  - (2) 将电池盖板盖好。
- Put 4 AA alkaline batteries in battery box as instructed.



## 7 装门扣盒、门扣板 Installing strike plate and side plate

- (1) 将门与门框靠紧，在门框上画出把手中心线；
- (2) 根据门框开孔图的要求画出开孔线；
- (3) 开孔，修槽；
- (4) 将门扣盒、门扣板装入门框中，并用3根M4\*25的沉头木螺丝固定在门框上。

（如果是铁门，请用四根M5\*15的机牙螺钉）  
Mark the door frame for drilling holes as per drilling view. Cut out the cavity for strike and strike plate. Put strike into the cavity, covered with strike plate, fix them on the door frame with 3 pcs of M4\*25 screws.

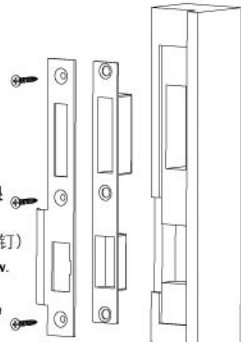

## 8 调试门锁 Test the lock as per operation instructions.

- (1) 转动把手，检查前后把手复位的灵活性；
- (2) 打出方舌，转动后把手开门，检查方舌、斜舌伸缩是否正常；
- (3) 用机械钥匙开门，检查钥匙转动的灵活性、方舌和斜舌伸缩是否正常；
- (4) 检查防插斜舌功能是否正常；
- (5) 关上后门后，斜舌和门扣板之间有0.5~1.5mm的活动间隙。

- (1) Rotate inside lever and hold. Ensure that the mortise latch is fully retracted and flush with the mortise faceplate. Release the inside lever; the latch should be fully extended.
- (2) To check the dead bolt function, rotate inside and out side lever upwards to fully extend the deadbolt. And rotate the inside lever the latch and the deadbolt should fully retracted and flush with the mortise faceplate. Release the inside lever; the latch should be fully extended.
- (3) Insert key into the outside lever. Rotate key counterclockwise to stop position and hold. Ensure that the latch is fully retracted and flush with the latch faceplate. Rotate the key clockwise to the horizontal position and remove the key. The latch should be fully extended.

## 9 装螺丝钉后盖板

- 盖上螺丝盖。  
Cover the back screw hole with plastic screw cover provided.

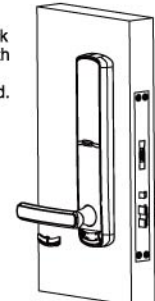

## 10 安装完成。（如下图） Installation completed

